

# ELECTRIC ACTUATORS E 65 - E 210



E 65 and E 110

## TECHNICAL DATA

Valve interface: EN ISO 5211

Type	E 65 WS	E 65 DS	E 65 GS	E 110 WS	E 110 DS
Operating time (0° - 90°)	6 s	6 s	6 s	12 s	12 s
Nominal torque	100 Nm	100 Nm	100 Nm	400 Nm	400 Nm
Nominal current	0,7 A	0,3 A	5,0 A	1,3 A	1,0 A
Starting current	1,0 A	0,3 A	8,0 A	2,0 A	1,8 A
Capacity:	0,16 kW	0,09 kW	0,08 kW	0,26 kW	0,22 kW
Nominal voltage	230 V	400 V	24 V	230 V	400 V
Frequency	50	50	-	50	50
ON-time	30%	30%	30%	30%	30%
Protection class	IP 67	IP 67	IP 67	IP 67	IP 67

Type	E 110 GS	E 160 WS	E 160 DS	E 160 GS	E 210 DS
Operating time (0° - 90°)	6 s	24 s	24 s	12 s	24 s
Nominal torque	360 Nm	1000 Nm	1000 Nm	800 Nm	3500 Nm
Nominal current	8,8 A	1,3 A	1,0 A	8,8 A	1,0 A
Starting current	12,5 A	2,0 A	1,8 A	12,5 A	3,2 A
Capacity:	0,4 kW	0,26 kW	0,22 kW	0,4 kW	0,54 kW
Nominal voltage	24 V	230 V	400 V	24 V	400 V
Frequency	-	50 Hz	50 Hz	-	50 Hz
ON-time	30%	30%	30%	30%	30%
Protection class	IP 67	IP 67	IP 67	IP 67	IP 67

## FEATURES

- Compact electric actuators with a robust, completely ball beared worm gear
- Safe arresting by self-inhibition
- Changeable clutch nuts for mounting on different shaft ends
- Mechanical position indicator disc for an optical control of the valve's position
- Motor with thermic winding protection switch
- Handwheel enables immediate hand emergency operation if necessary
- Maintenance-free, long life service by continuous lubrication

## GENERAL APPLICATIONS

- Water and wastewater technology
- Chemical Industry
- Car Industry
- Civil engineering



E 160 and E 210

# DIMENSIONS E 65 - E 210

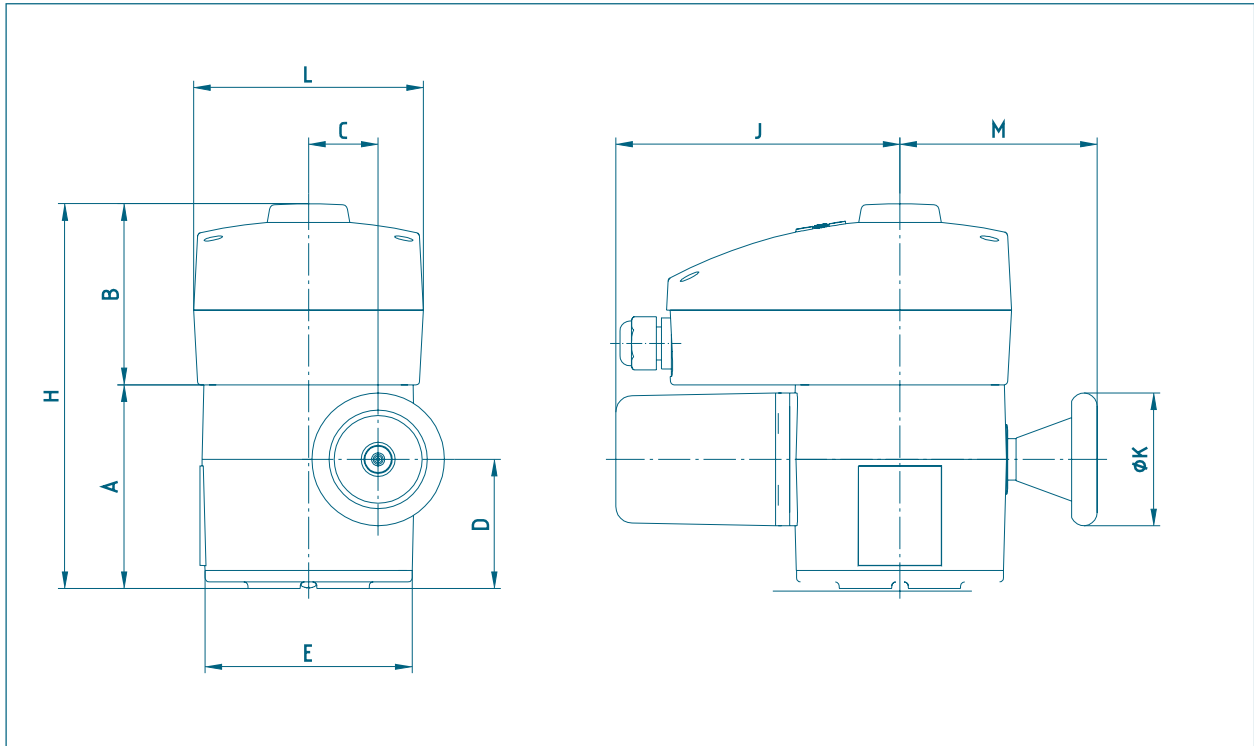

Type	Dimensions [mm]										Weight [kg]
	A	B	C	D	E	H	J	K	L	M	
E 65	123	110	42	78	125	233	172	80	139	119	7
E 110	141	110	58	86	150	251	245	125	139	134	14
E 160	130	110	89	77	175	239	279	198	139	157	25
E 210	166	110	125	88	240	278	369	315	139	215	40

Subject to change without notice.

# OPTIONS

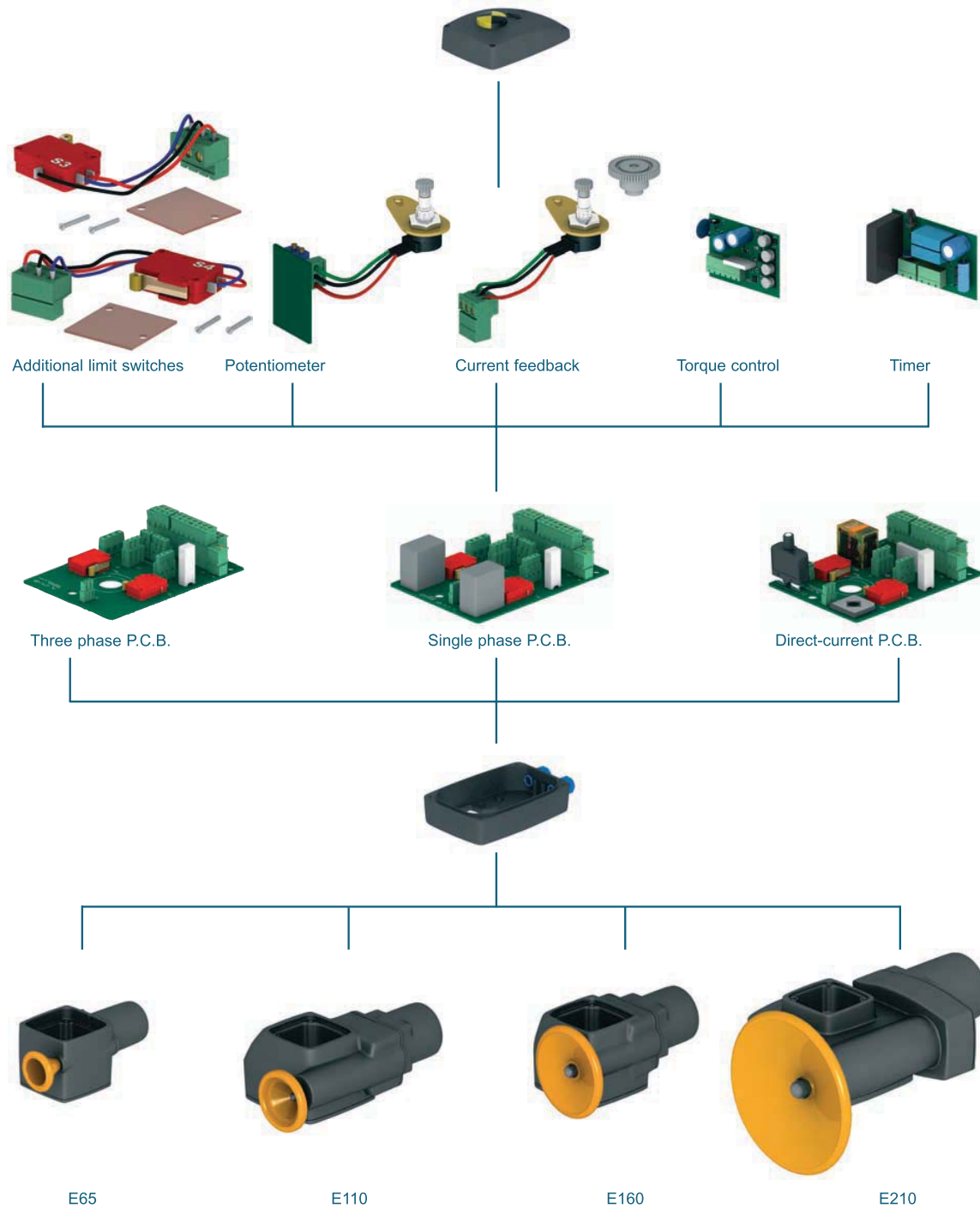

# CERTIFICATE



## Declaration of conformity

CE

We, **EBRO ARMATUREN**  
**Gebr. Bröer GmbH, Karlstraße 8, 58135 Hagen, Germany**

declare in our sole responsibility, that the electric quarter-turn actuators of the E-series,

<b>E 65 WS</b>	<b>E 110 WS</b>	<b>E 160 WS</b>	
<b>E 65 DS</b>	<b>E 110 DS</b>	<b>E 160 DS</b>	<b>E 210 DS</b>
<b>E 65 GS</b>	<b>E 110 GS</b>	<b>E 160 GS</b>	

this declaration is valid for, fulfil the requirements of the guideline rights of the european member states about EMC directive (89/336/EWG) and the low voltage directive 73/23/EWG (NSR).

For assessment of these products related to electromagnetic compatibility and low voltage directive following standards have been consulted:

**EN 50178 : 1997**  
**EN 61010 -1 : 1993** for low voltage directive

**EN 55011 : 1998**  
**EN 61000** for EMC directive

As manufacturer of these products, we declare additionally, that following standards according to machinery directive 89/392/EWG have been consulted:

**EN ISO 5211**  
**EN 60068-2-52**  
**EN IEC 60529** acc. to machinery directive 89/392/EWG

The starting is not permitted till it is ensured, that the complete machine, where EBRO quarter-turn actuators are installed, fulfil the guidelines of directive 89/392/EWG.

Hagen, dated 8.11.2004

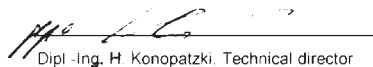
  
Dipl.-Ing. H. Konopatki, Technical director



**V&A**

[www.valve.co.za](http://www.valve.co.za)

Johannesburg Tel : 011-397 2833  
Fax : 011-397 4700  
E-mail : [sales.jhb@valve.co.za](mailto:sales.jhb@valve.co.za)  
Durban Tel : 031-579 2593  
Fax : 031-579 2562  
E-mail : [sales@valve.co.za](mailto:sales@valve.co.za)